

STERN®

Austria

CIRCULAR SAW CSL185L

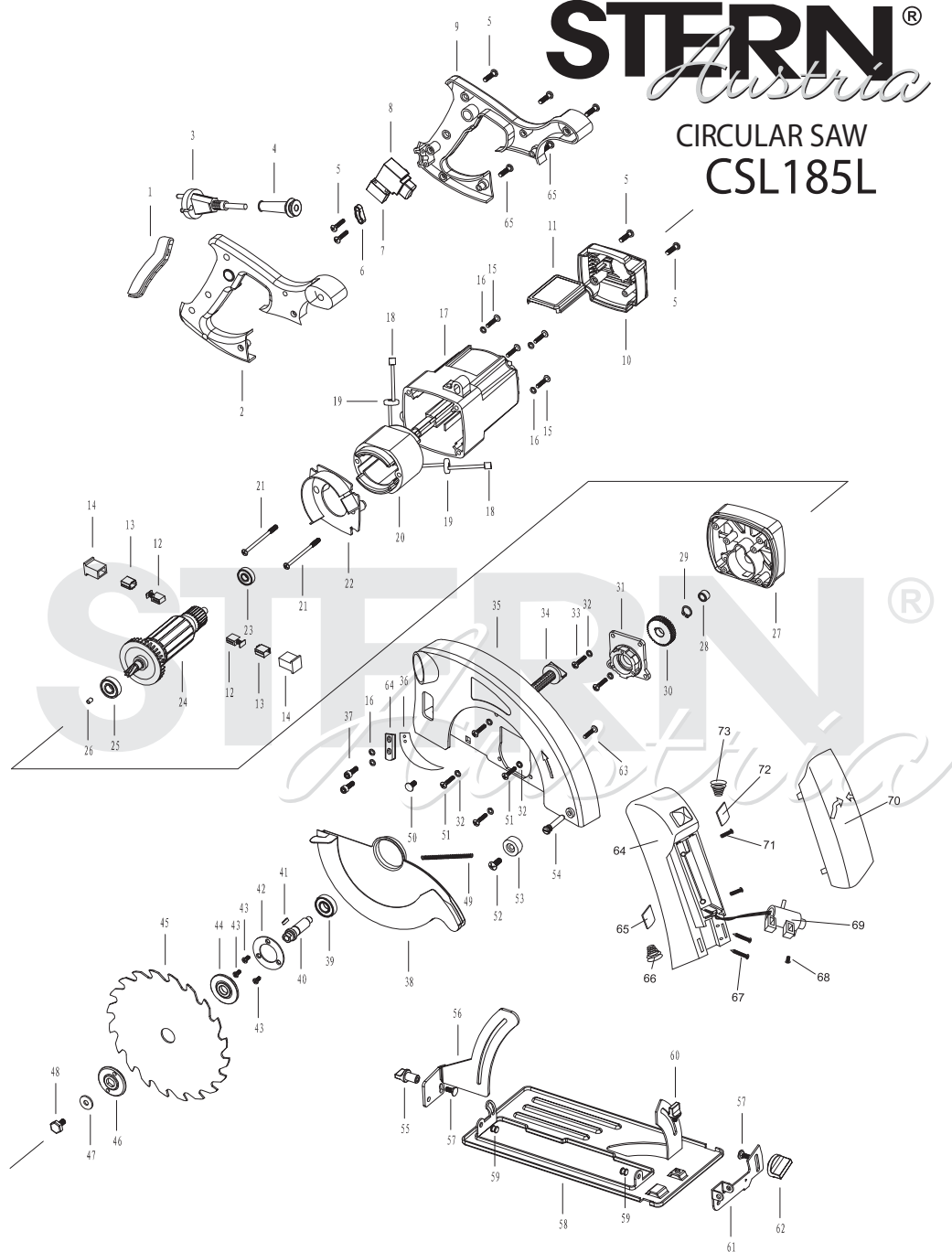

STERN®

Austria

CIRCULAR SAW CSL185L

NO.	DESCRIPTION	NO.	DESCRIPTION
1	SOFT HANDLE COVER	39	BEARING 6001
2	RIGHT HANDLE	40	OUTPUT SHAFT
3	CORD & PLUG	41	WOODRUFF KEY
4	CORD SLEEVE	42	BEARING COVER
5	SCREW	43	SCREW
6	CORD ANCHORAGE	44	INNER FLANGE
7	CAPACITOR	45	SAW BLADE
8	SWITCH	46	OUTER FLANGE
9	LEFT HANDLE	47	PLAIN WASHER
10	REAR COVER	48	HEX SCREW
11	DECORATED BOARD	49	PULLING SPRING
12	CARBON BRUSH	50	SCREW
13	BRUSH COPPER NEST	51	SCREW
14	BRUSH HOLDER	52	SCREW
15	SCREW	53	RUBBER BLOCK
16	SPRING WASHER	54	CONNECTION SCREW
17	HOUSING	55	KNOB FOR ANGLE ADJUSTMENT (I)
18	ELECTRIC CONNECT PIECE	56	DEPTH STAND
19	INDUCTOR	57	SCREW
20	STATOR	58	BASE PLATE
21	SCREW	59	RIVET
22	WIND GUARD	60	SCREW FOR FIXED PARALLEL GUIDE
23	BEARING 608	61	ANGLE STAND
24	ROTOR	62	KNOB FOR ANGLE ADJUSTMENT (II)
25	BEARING 6000	63	SCREW
26	RUBBER PILLAR	64	CABINET
27	CENTRAL SUPPORTER	65	REED
28	OILED BEARING	66	SPRING
29	CIRCLIP	67	SCREW
30	BIG GEAR	68	SCREW
31	BEARING BASE	69	LASER POINTER
32	SPRING WASHER	70	COVER
33	SCREW	71	SCREW
34	KNOB FOR DEPTH ADJUSTMENT	72	REED
35	FIXED GUARD	73	SPRING
36	RIVING KNIFE	74	SAFETY BLOCK
37	HEX SCREW	75	TAPPING SCREW
38	MOVING GUARD		